

itho

Hot and boiling water products





Model Shown | Gusto Chrome

Boiling water straight from the tap is the latest trend in the kitchen at home and at the office. Making a cup of tea, peeling tomatoes or boiling an egg will only take a fraction of the usual time. A practical kitchen appliance that will prove its effectiveness every day.

Instant **boiling water** at your fingertips

ltho surpasses all competition by offering innovative and convenient products delivering hot water, boiling water, or even both, instantly. The entire system consists of a special boiling water tap and a heater that is built in under the sink. There are two versions of the boiling water heaters. The H2OTAP is a compact boiling water heater that easily fits behind the kitchen plinth. The H2OTAP+ is ltho's most powerful kitchen water heater. This system will instantly provide you with a generous amount of boiling and hot water.

Do you want a separate boiling water tap, or a 3-in-1 Tap for boiling, hot and cold water? Which tap fits the style of your kitchen at home or the office? A modern square design tap or do you prefer an elegant, rounded model? The taps can be fully rotated, making it possible to install them for left-handed and right-handed use.

H2OTAP Benefits – heater

- Instant boiling water.
- Instant hot water.
- Space saving plinth water heater (4.5 litre)
- Behind the plinth installation (unique in Europe)
- Under cupboard installation. Only 14 cm high!
- Boiling water at 100°C (unlike majority of competitors)
- Saves water and energy.
- Heating time from cold to fully loaded (5 litre unit 22 minutes, 10 litre unit 35 minutes).
- Standing loss 32 Watts per hour / £ 0.09 per day.
- Copper vessel.
- 5 years warranty on vessel. 2 years on parts.
- 5 Litre unit is maintenance free (fit and forget), 10 litre unit easy to maintain (no expensive service contract)



H2OTAP:

- Instant boiling water, up to 2,7 litres
- Compact, even fits behind the kitchen plinth, no wasted storage space
- With optional Combi Installation set
- Instant hot water, up to 14 litres



H2OTAP+:

- Instant boiling water, up to 7,5 litres
- Instant hot water, up to 32 litres

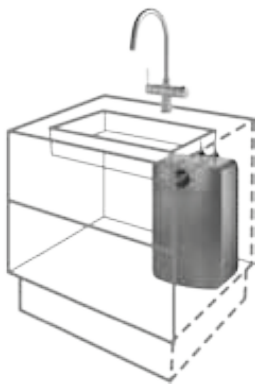

Close-in Compact :

- Instant hot water, up to 14 litres (40°C)
- Saves water and energy
- Smallest model fits behind the kitchen plinth

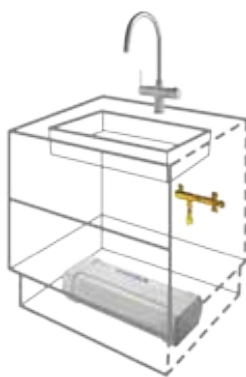

H2OTAP Benefits – tap

- Cold, hot and filtered instant boiling water from 1 tap (3-in-1).
- Boiling only model available with optional matching mixer.
- No design clash and space saving on the counter top.
- Saves a standard mixing tap (£ 180+).
- Hole size identical to normal mixer tap (35 mm).
- Retrofit possibilities.
- Cool touch spout (patented tube-in-tube).
- Cool touch body (patented).
- Safe push-turn knob with built-in recoil spring (boiling).



Boiling Water Tap Caldo:

- Delivers boiling water
- Child-friendly safety feature with a recoil spring in the push-turn knob
- Matching kitchen mixer tap available



3-in-1 Tap Dolce/Gusto:

- Child-friendly safety feature with a recoil spring in the push-turn knob
- Fits the existing mixer tap hole
- Delivers cold, hot and boiling water

Safety, our highest priority

Safety is paramount in all of our products, and where boiling water is involved it is even more crucial. All of our boiling water taps are equipped with a child safety feature using a recoil spring in the push-turn knob. This prevents unintentional or unguarded use of the boiling water tap, the recoil spring immediately stops the water jet when the button is released. In addition, the design of the outflow keeps the temperature on the outside of the spout at a safe level, the water jet is very compact, in order to reduce splashing to a minimum.

Safety

The boiling water taps by Itho have been equipped with various techniques in order to guarantee safety.

Tube in tube

In the outflow of the 3-in-1 tap, this technique separates the boiling water completely from the hot and cold water. This prevents boiling water from flowing out when you are running hot or cold water. It also keeps the tap cool to the touch.

Push-turn knob

In order to prevent unintentional use of boiling water, the boiling water taps are equipped with a push-turn knob. You have to push and turn the button before you can run boiling water. For instant switch off release the button immediately causing the recoil spring to stop the flow.

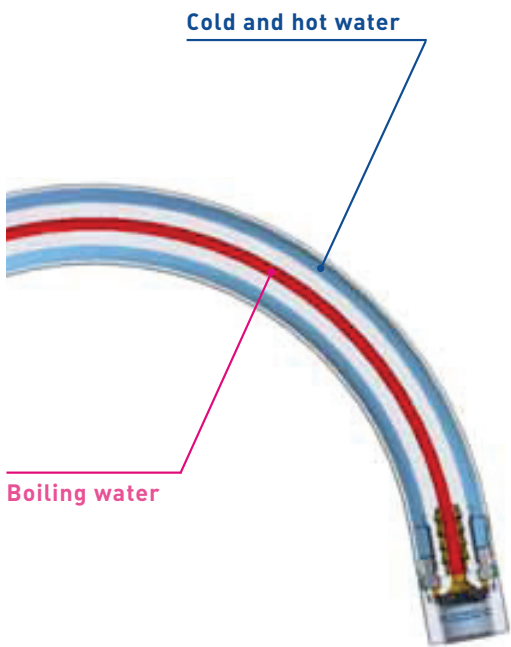

Compact water flow

The design of the flow-reducing nozzle ensures a compact, quiet boiling water flow. This limits splashing as much as possible.

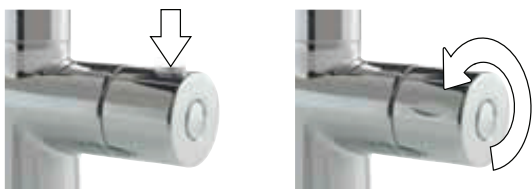

Push-turn knob

Specifications per type:

	Close in Compact 590-0050	H ₂ Otap 590-0001	H ₂ Otap+ 590-0030
Tapping capacity boiling water (litres at 100 °C)*	not applicable	2,7	7,5
Tapping capacity hot water (litres at 55 °C) **	8 vertically 6 horizontal	7***	20***
Tapping capacity hot water (litres at 40 °C) **	14 vertically 13 horizontal	14 with external optional mixing valve	32
Total capacity (litre)	5	4,7	10
Max. temperature in vessel (°C)	80	115	108
Voltage (V)	230	230	230
Power (Watt)	1500	1500	2200
Current (Ampere)	6	7	10
Heating time (minutes)	15 vertically 19 horizontal	22	35
Standing loss (W/h)	18,93 vertically 18,64 horizontal	32	28
Connections	3/8 ext. inch	½ ext. inch M10 x 1,25	½ ext. inch 10 mm compression M10 x 1,25
Working pressure (kPa)	800	600	600
Material vessel	99,9% copper	99,9% copper	99,9% copper
Height (mm)	143	143	452
Width (mm)	550	550	300
Depth (mm)	211	211	285
Weight (empty, kg)	4,5	4,5	10

* Results
** Capacity calculated on max. [settable] vessel temperature/ Cold water inlet temperature 15 °C
*** Capacity calculated on max. fixed vessel temperature/ Cold water inlet temperature 15 °C

Accessories

Combi Installation Set: suitable for the H2Otap. Install the Combi Installation Set between the H2Otap and your tap, you will be able to draw hot water from your boiling water heater.

Combi set code: 590-2000

Filter set: suitable for the H2Otap and H2Otap+. Using the filter set water will be purified before it flows out of tap. The filter set is installed between the cold water main and your inlet pressure valve.

Filter set codes H2OTap 590-2100
Filter set codes H2OTap + 590-2130

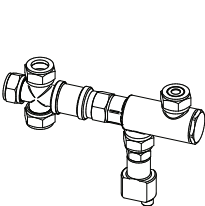

Combi Installation Set

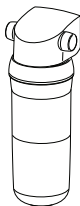

Filter set

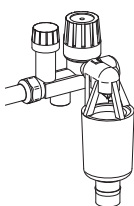

Pressure Relief Valve

Pressure Relief Valve: regulates the pressure in the boiler and is obligatory in all Itho water heaters.

Pressure Relief Valve 590-4012

Pressure Reduction Valve: Reduces main pressure to 4 bar.

Pressure Reduction Valve-.....

Extension hose Boily: increases the distance between Boily and taps, 50 cm.

100 degree hose 590-4041
Hot & cold hoses (set of 2) 590-4042



Model Shown | Caldo Chrome (at rear) & Dolce Chrome



You will find more information on the Itho hot and boiling water products in the little blue book. This will help you determine which boiler is most suitable for your situation.

Assortment of taps

3-in-1 tap Modern: the 3-in-1 tap delivers cold, hot and boiling water. We offer a range of 4 distinct models for the 3-in-1 tap Modern – in chrome or stainless steel, and in a square or round version. The 3-in-1 tap fits the existing hole of your mixer tap (Ø 35mm).

Flow rate tap at 3 bar	All Taps
Mixed water (cold/warm)	10 litre per min.
Boiling water	3 litre per min.



Chrome round DOLCE
590-1010



Stainless Steel round Dolce
590-1035



Chrome Square Gusto
590-1060



Stainless Steel Square Gusto
590-1085

Tap set Modern: if you prefer a separate boiling water tap, we offer the boiling water tap Modern and a matching kitchen mixer tap Modern.

Additional option: both the 3-in-1 taps and the kitchen mixer tap come with a short lever (in both chrome and stainless steel) in situations where there is not enough space for the longer lever to operate (if installed close to the wall).



Chrome round Mite
590-1250



Chrome round Caldo
590-1200



Short lever (64 mm)
chrome 590-4037
stainless steel 590-4038

VISIT WWW.ITHOUK.CO.UK



- Register your warranty
- Order Filters & Spare Parts
- Read our frequently asked questions
- Place a service call

www.ithouk.co.uk | www.ithouk.co.uk | www.ithouk.co.uk

Guarantee

All of the products sold by Itho come with a 2 year warranty on parts and 5 year guarantee on tank.

